

Hose Type 25/2W



Applications

Hydraulics : Controls for Service Equipment, Hydraulic Jacks, Pressure Testing for Valves, Tooling and Control Panels
Oil and Gas : Gaseous Media Handling, Grease Injection, Hydraulic Control, Nitrogen Service

Inner Core : Polyamide (PA)
Pressure Support : 4 layers of high-tensile steel wire
Outer Cover : Polyurethane (PUR)
Colour : black, other colours upon request
Temperature : -22°F to 140°F [-30°C to +60°C]



Ø ID	Ø OD	Working Pressure*)	Burst Pressure 1)	Min. Bend Radius	Weight	Nipple Ø ID	Sleeve	Sleeve Ø OD
0,98 inch	1,40 inch	9.280 psi	23.200 psi	11,02 inch	1,001 lbs/ft	0,65 inch	12530111W carbon steel	1,73 inch
25,0 mm	35,6 mm	640 bar	1.600 bar	280 mm	1,490 kg/m	16,5 mm		44,0 mm

Fittings : ID 25, Series T

Description	Size	Material	Part Number
metric female swivel with O-Ring	M42x2	carbon steel	22530201T / 52520201

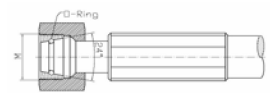

---- Additional fittings are available upon request. ----

¹⁾Production related variations up to 5 % are possible

^{*}) The safety factors between the burst pressure and the working pressure as well as the test pressure depend on the operating conditions. For gaseous media the outer cover is to be pinpricked. Regarding the safety factor for gaseous media please contact your local SPIR STAR[®] assembling center. The indicated working pressure refers to the hose only. Depending on the used fitting the permitted working pressure of a hose assembly can be less. We reserve our rights for changes without notice.

