

90°

PS 系列

旋转接头

SAE内管螺纹 - SAE内管螺纹

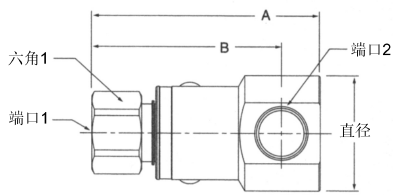

三件式设计

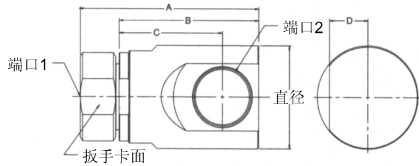

型号	A	B	直径	六角1	端口1	端口2
PS491010-4-4	2.87" 72.8mm	2.46" 62.5mm	1.20" 30.5mm	.75" 19.0mm	7/16-20 UNF-2B	7/16-20 UNF-2B
PS691010-6-6	3.19" 80.9mm	2.68" 68.0mm	1.29" 32.8mm	.88" 22.2mm	9/16-18 UNF-2B	9/16-18 UNF-2B
PS891010-8-8	3.46" 87.8mm	2.87" 72.8mm	1.73" 44.0mm	1.12" 28.6mm	3/4-16 UNF-2B	3/4-16 UNF-2B
PS1291010-12-12	4.04" 102.6mm	3.37" 85.6mm	2.17" 55.2mm	1.38" 35.0mm	1-1/16-12 UN-2B	1-1/16-12 UN-2B
PS1691010-16-16	4.45" 113.0mm	3.58" 91.0mm	2.48" 63.0mm	1.62" 41.3mm	1-5/16-12 UN-2B	1-5/16-12 UN-2B

型号	A	B	C	D	扳手卡面	直径	端口1	端口2
PS491010-20-20	5.91" 150.2mm	4.63" 117.5mm	3.43" 87.0mm	1.27" 32.3mm	2.63" 66.7mm	3.36" 85.2mm	1 5/8 12 UN-2B	1 5/8 12 UN-2B
PS491010-24-24	5.91" 150.2mm	4.63" 117.5mm	3.43" 87.0mm	1.27" 32.3mm	2.63" 66.7mm	3.36" 85.2mm	1 7/8 12 UN-2B	1 7/8 12 UN-2B
PS491010-32-32	6.83" 179.8mm	5.45" 138.4mm	3.93" 99.7mm	1.52" 38.5mm	3.06" 77.6mm	4.19" 106.4mm	2 11/16 12 UN-2B	2 1/2 12 UN-2B

SAE内管螺纹 - O形圈平面密封

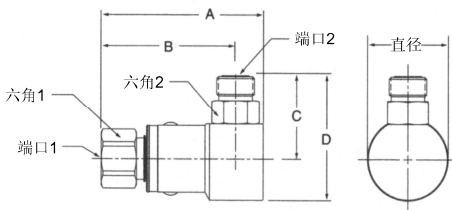

型号	A	B	C	D	直径	六角1	六角2	端口1	端口2
PS4910JM-4-4	2.87" 72.8mm	2.46" 62.5mm	1.29" 32.5mm	1.89" 47.9mm	1.20" 30.5mm	.75" 19.0mm	.56" 14.3mm	7/16-20 UNF-2B	9/16-20 UNF-2A
PS6910JM-6-6	3.19" 80.9mm	2.68" 68.0mm	1.40" 35.6mm	2.05" 52.0mm	1.29" 32.8mm	.88" 22.2mm	.69" 17.5mm	9/16-18 UNF-2B	11/16-16 UNF-2A
PS8910JM-8-8	3.46" 87.8mm	2.87" 72.8mm	1.74" 44.1mm	2.60" 66.1mm	1.73" 44.0mm	1.12" 28.6mm	.88" 22.2mm	3/4-16 UNF-2B	13/16-16 UN-2A
PS12910JM-12-12	4.04" 102.6mm	3.37" 85.6mm	2.18" 55.4mm	3.27" 83.0mm	2.17" 55.2mm	1.38" 35.0mm	1.25" 31.8mm	1-1/16-12 UN-2B	1-3/16-12 UN-2A
PS16910JM-16-16	4.45" 113.0mm	3.58" 91.0mm	2.34" 59.6mm	3.59" 91.1mm	2.48" 63.0mm	1.62" 41.3mm	1.50" 38.1mm	1-5/16-12 UN-2B	1-7/16-12 UN-2A

O形圈平面密封 - 美制锥管内螺纹

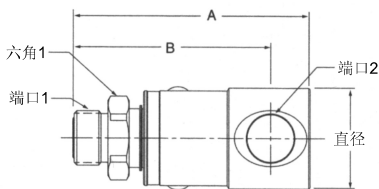

型号	A	B	直径	六角1	端口1	端口2
PS49JM02-4-4	2.99" 76.0mm	2.59" 65.7mm	1.20" 30.5mm	.75" 19.0mm	9/16-20 UNF-2A	1/4-18 NPTF
PS69JM026-6	3.27" 83.0mm	2.76" 70.0mm	1.29" 32.8mm	.88" 22.2mm	11/16-16 UN-2A	3/8-18 NPTF
PS89JM02-8-8	3.52" 89.5mm	2.93" 74.5mm	1.49" 37.8mm	1.12" 28.6mm	13/16-16 UN-2A	1/2-14 NPTF
PS129JM02-12-12	4.04" 102.6mm	3.37" 85.6mm	1.76" 44.6mm	1.38" 35.0mm	1-3/16-12 UN-2A	3/4-14 NPTF
PS169JM02-16-16	4.45" 113.0mm	3.58" 91.0mm	2.16" 54.9mm	1.62" 41.3mm	1-7/16-12 UN-2A	1/11-1/2 NPTF

O形圈平面密封 - 37°扩口式

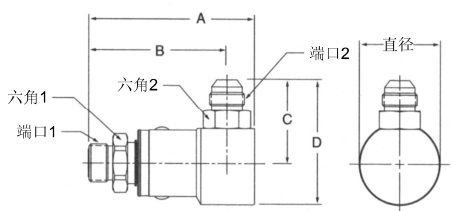

型号	A	B	C	D	直径	六角1	六角2	端口1	端口2
PS49JM03-4-4	2.99" 76.0mm	2.59" 65.7mm	1.39" 35.2mm	1.99" 50.5mm	1.20" 30.5mm	.75" 19.0mm	.56" 14.3mm	9/16-18 UNF-2A	7/16-20 UNF-2A
PS69JM03-6-6	3.27" 83.0mm	2.76" 70.0mm	1.44" 36.6mm	2.09" 53.0mm	1.29" 32.8mm	.88" 22.2mm	.69" 17.5mm	11/16-16 UN-2A	9/16-18 UNF-2A
PS89JM03-8-8	3.52" 89.5mm	2.93" 74.5mm	1.78" 45.1mm	2.64" 67.1mm	1.73" 44.0mm	1.12" 28.6mm	.88" 22.2mm	13/16-16 UNF-2A	3/4-16 UNF-2A
PS129JM03-10-10	3.62" 92.0mm	3.03" 77.0mm	1.90" 48.4mm	2.77" 70.4mm	1.73" 44.0mm	1.12" 28.6mm	.88" 22.2mm	7/8-14 UN-2A	7/8-14 UNF-2A
PS169JM03-12-12	4.04" 102.6mm	3.37" 85.6mm	2.24" 56.9mm	3.86" 98.3mm	2.17" 55.2mm	1.38" 35.0mm	1.25" 31.8mm	1-3/16-12 UN-2A	1-1/16-12 UN-2A
PS169JM03-16-16	4.45" 113.0mm	3.58" 91.0mm	2.42" 61.3mm	3.66" 92.9mm	2.48" 63.0mm	1.62" 41.3mm	1.50" 38.1mm	1-7/16-12 UN-2A	1-5/16-12 UN-2A

C 旋转接头