

旋转接头

直通型 PS 系列

美制锥管外螺纹 - SAE内管螺纹

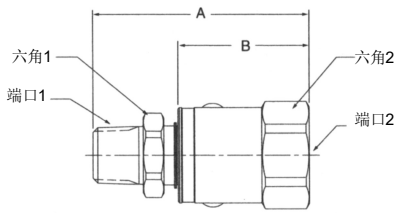

型号	A	B	六角1	六角2	端口1	端口2
PS410110-4-4	2.87" 72.9mm	1.85" 47.0mm	.75" 19.0mm	1.19" 30.2mm	1/4-18 NPTF	7/16-20 UNF-2B
PS610110-6-6	2.98" 75.6mm	1.92" 48.8mm	.88" 22.2mm	1.31" 33.3mm	3/8-18 NPTF	9/16-18 UNF-2B
PS810110-8-8	3.24" 82.2mm	1.96" 50.0mm	1.12" 28.6mm	1.50" 36.5mm	1/2-14 NPTF	3/4-16 UNF-2B
PS1210110-12-12	3.46" 87.8mm	2.16" 55.0mm	1.38" 35.0mm	1.69" 42.9mm	3/4-14 NPTF	1-1/16-12 UNF-2B
PS1610110-16-16	3.74" 95.1mm	2.26" 57.4mm	1.62" 41.3mm	1.88" 47.6mm	1/11 1/2 NPTF	1-5/16-20 UNF-2B

美制锥管外螺纹 - O形圈平面密封

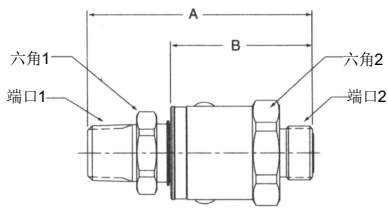

型号	A	B	六角1	六角2	端口1	端口2
PS4101JM-4-4	2.99" 76.0mm	1.97" 50.0mm	.75" 19.0mm	1.19" 30.2mm	1/4-18 NPTF	9/16-18 UNF-2A
PS6101JM-6-6	3.14" 79.6mm	2.08" 52.8mm	.88" 22.2mm	1.31" 33.3mm	3/8-18 NPTF	11/16-16 UN-2A
PS8101JM-8-8	3.44" 87.4mm	2.17" 55.1mm	1.12" 28.6mm	1.50" 36.5mm	1/2-14 NPTF	13/16-16 UN-2A
PS12101JM-12-12	3.65" 92.8mm	2.36" 60.0mm	1.38" 35.0mm	1.69" 42.9mm	3/4-14 NPTF	1-3/16-12 UN-2A
PS16101JM-16-16	3.84" 97.6mm	2.36" 60.0mm	1.62" 41.3mm	1.88" 47.6mm	1/11 1/2 NPTF	1-7/16-16 UN-2A

美制锥管外螺纹 - 美制锥管内螺纹

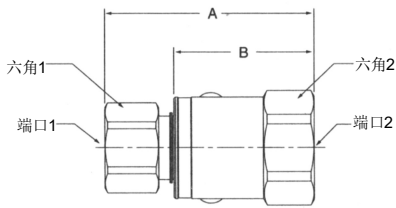

型号	A	B	六角1	六角2	端口1	端口2
PS410202-4-4	2.60" 66.1mm	1.85" 47.0mm	.75" 19.0mm	1.19" 30.2mm	1/4-18 NPTF	1/4-18 NPTF
PS610202-6-6	2.77" 70.4mm	1.92" 48.8mm	.88" 22.2mm	1.31" 33.3mm	3/8-18 NPTF	3/8-18 NPTF
PS810202-8-8	2.93" 74.4mm	1.96" 50.0mm	1.12" 28.6mm	1.50" 36.5mm	1/2-14 NPTF	1/2-14 NPTF
PS1210202-12-12	3.14" 79.6mm	2.16" 55.0mm	1.38" 35.0mm	1.69" 42.9mm	3/4-14 NPTF	3/4-14 NPTF
PS1610202-16-16	3.40" 86.2mm	2.26" 57.4mm	1.62" 41.3mm	1.88" 47.6mm	1/11 1/2 NPTF	1/11-1/2 NPTF

三件式设计

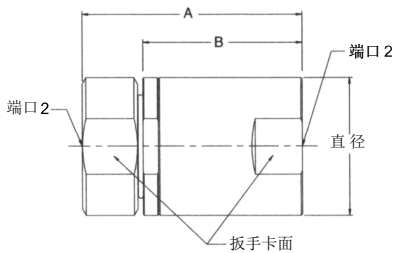

型号	A	B	扳手卡面	直径	端口1	端口2
PS2410202-20-20	4.67" 118.6mm	3.38" 85.9mm	2.63" 66.7mm	2.88" 73.0mm	1 1/4-11 1/2 NPTF	1 1/4-11 1/2 NPTF
PS2410202-24-24	4.67" 118.6mm	3.38" 85.9mm	2.63" 66.7mm	2.88" 73.0mm	1 1/2-11 1/2 NPTF	1 1/2-11 1/2 NPTF
PS2410202-32-32	4.88" 123.9mm	3.58" 90.8mm	3.06" 77.6mm	3.35" 85.1mm	2-11 1/2 NPTF	2-11 1/2 NPTF